

# Measure & Plan

Step-by-step instructions for measuring and planning your  PaperStone® project



## 1. Tools needed for measuring and templating [1A]

- Measuring tape
- Pen/pencil (a silver marker works well, marks can be removed with acetone or lacquer thinner) [1B]
- Material for templating
  - Cardboard, drafting paper, plastic sheets **or**
  - 1/8" luan strips **or** lath
- Level
- Straight edge/square
- Hot glue gun with glue (for use with plywood strips or lath)
- Sink/stove templates (included with sink/stove or available online)

## 2. Check cabinet installation

- Make sure cabinets are in place, anchored correctly, clean of any debris and that tops are level [1C]
- If cabinets are not level, adjust with shims and secure properly

## 3. Create drawing of countertops

- Draw the layout of your desired countertops [1D]
- Measure carefully and include all vital measurements
- Include sink, faucet and stove center points
- Make sure sink, faucet, and/or stove will fit into cabinet bases [1E]

## 4. Obtain sink and stove templates

- Templates should be packaged with sink and/or stove, or available online [1F]

## 5. Make countertop template

### Template option A

- Create an accurate template of your countertop from drafting paper, cardboard or plastic sheeting
  - place template material on cabinet bases
  - trace perimeter of cabinet bases on the underside of the template material [1G]
  - make accurate notes/markings for the location and boundaries of the sink cabinet base [1H]
  - note and explain all overhangs, radius corners, finished edges, etc.
  - scribe template material to wall (if a backsplash will be installed over countertop, the fit between the countertop and the wall can be less accurate)
    - flip template material over and complete the tracing of the perimeter and sink/stove cutout areas (include overhangs by measuring from the traced perimeter to the desired overhang and mark with a straight edge)

(next page) >>>

## Measure & Plan (continued)



### 5. Make countertop template

#### Template option B

- Create outline template by hot gluing together 1/8" luan strips or lath
  - build an outline of the cabinet bases by laying out strips of luan on the perimeter [1I], [1J] and [1K]
  - use plenty of support strips
  - build an outline of all cutouts (sink/stove/etc.)
  - hot glue all joints of template strips so you have one continuous template [1I]
  - make notes on the strips explaining overhangs, radius corners, finished edges, etc. [1K]

### 6. Order your panels

- Figure out total material requirements and order correct size panel(s) [Fig. II]

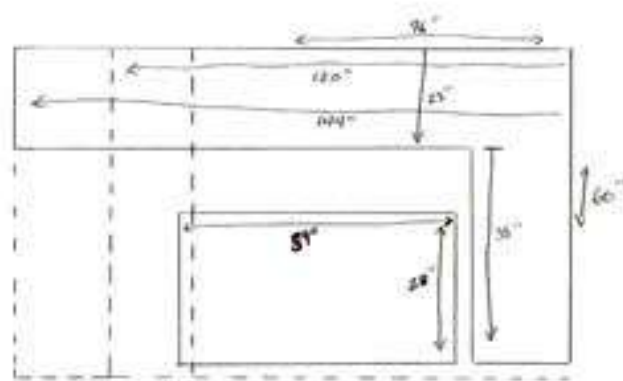

Fig. II

NEXT: ORDER PANELS >>